

Ride-Ezy

UK
CA CE



HECTOR HELMET MANUAL

Ride-ezy. Global Opportunities
Unit 23 Link Business Centre, Malvern WR14 1UG
Aftersales support at support@globalopportunities.co.uk



Notification

This helmet is used for outdoor sports such as scooters, bicycles, roller skates. Not suitable for motorcycles.

1. No helmet can completely avoid all unpredictable impacts. The main role of the helmet is to reduce the degree of injury. Serious injuries and deaths may also occur.
2. The helmet can only protect if it fits well and the buyer should try different sizes and choose the size which feels secure and comfortable on the head.
3. After a heavy impact, even if there is no obvious damage, the helmet may not have enough protection to protect the head from a second impact. If it has occurred, users are advised to replace it with a new helmet.
4. It is dangerous to modify or remove any of the original parts of the helmet other than as recommended by the manufacturer, and that helmets should not be adapted for the purpose of fitting accessories in a way not recommended by the manufacturer.

How to use the adjuster

The purpose of the adjustment is to ensure a good fit. Turning it clockwise tightens it, anti clockwise is loosening.

If it is not adjusted properly, the helmet may move or fall off when an accident occurs. The correct operation method of the rotary regulator is shown in the figure below

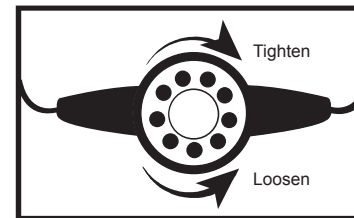

Use of warning light

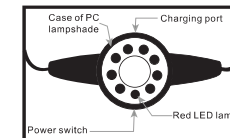

Lighting mode: four modes

1. Press the power switch once (sharp flashing). It can be used for 5 hours when fully charged.
2. Press the power switch twice (quick flashing). It can be used for 25 hours when fully charged.
3. Press the power switch three times (slow flashing). It can be used for 5 hours when fully charged.
4. Press the power switch four times (Circle cyclic flashing). It can be used for 7 hours when fully charged.
5. Press and hold the power switch continuously for 3 seconds to turn off the power.

Fully charged in 1 hour
After receiving the goods, it is recommended to charge for one hour before use.

How to use buckle, adjust the strap

1. The clip is aligned with the buckle, and it is firmly fastened and will not fall off. (Figure 1)
2. When you want to unclip, squeeze it. (Figure 2)

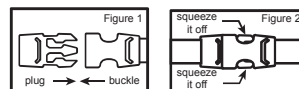

3. If the strap is too tight, it can be loosened as shown in (Figure 3).
4. If the strap is too loose, it can be tightened as shown in (Figure 4).

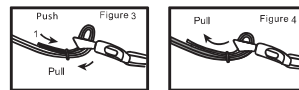

How to wear

1. Keep the helmet level and not tilted forwards or backwards.
2. When wearing the helmet correctly, adjust the thickness of the cross under the ear(A), about 1.5 cm. The entire strap is locked under the lower jaw(B), not the throat. It is also necessary to allow about 1.5 cm, to reach the degree of looseness of one finger. (As shown below).

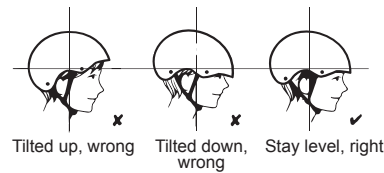

Cross regulation band is about 1.5cm below the ear, A

B. A finger can be inserted under the strap below jaw

How to clean and maintain

1. When the helmet is used frequently, dirt will often accumulate inside the helmet and it could be odorous. In such cases, it should be cleaned. The cleanser used should be neutral and shampoo is a safer option. To avoid odours from cleaning agents, minimise their use. When brushing the inside of the helmet, do not use too much force, otherwise, it will deform the cushioning material and lose its function. After cleaning, wipe off the moisture with a towel or paper and air dry in a ventilated place. Do not use a hairdryer.
2. The helmet surface is more prone to dirt, so wiping the surface should be done regularly. When the helmet is stained, first wipe the stain with a damp cloth, and then wipe it with water wax or polishing wax to make the helmet clean and shiny. Also you can use a helmet specific brightener. Do not use strong corrosive items, such as Tianna water, sulphuric acid, etc. Keep away from high temperatures.
3. The helmet can be damaged if exposed to high temperatures over 65.5 degrees Celsius. As a result, deformation can occur to the helmet, and the helmet will become blistered or uneven.
4. The KY-B007 helmet has a 'service life of 5 years. It is recommended to replace the helmet every 5 years even if there is no collision damage in normal use.

About us

UK
CA CE

This product complies with UK & European safety and electrical interference directives



This product complies with the US CPSC 1203/CPS 1303 and ASTM F 1447-18

Designed in the UK
Made in China

Product name:	Hector with LED lights	
Model:	Hector KY-8007	
Material:	ABS shell • EPS buffer layer • PVC soft rubber Hemming	
Battery capacity:	200mAh	
Standby time:	60 days	
Charging input:	5V 0.5A-2.5A	
Current-voltage:	3.7v	
Charging time:	1 hour on a full charge	
Charging port:	Type-C	
Power:	2.77SWH	
Battery life:	(sharp flashing): 5 hours. (quick flashing): 25 hours. (slow flashing): 5 hours. (Circle cyclic flashing): 7 hours	
Size:	Small	Medium
Applicable head Circumference:	48-53cm	54-57cm
Product Weight:	270grams	390grams